



## **TECNOLOGIE DI FISSAGGIO**

FISSAGGI AUTORIBADENTI PER LAMIERA

FISSAGGI A CONIARE PER LAMIERA

FISSAGGI AUTOBROCCIANTI PER SCHEDE ELETTRONICHE

VITI IMPERDIBILI



PRESSE PER AUTORIBADENTI PRIMA INSERTER

INSERTI PER SALDATURA

# FISSAGGI A CONIARE PER LAMIERA

## dadi a coniare

### Dimensioni e specifiche

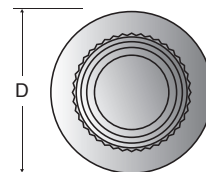
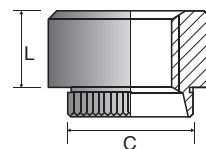

 M	 Standard	 Ø +0.1-0.0	D ±0.13	L ±0.13	C +0.0-0.13
M2.5 X 0.45*	10-20 Swg	5.90	7.92	3.17	5.90
M3 x 0.5	10-20 Swg	5.90	7.92	3.17	5.90
M3.5 x 0.6*	10-20 Swg	6.95	9.52	3.17	6.95
M4 x 0.7	10-20 Swg	6.95	9.52	3.17	6.95
M5 x 0.8	10-20 Swg	8.35	11.10	3.81	8.35
M6 x 1.0	10-20 Swg	9.65	12.70	5.08	9.65
M8 x 1.25	10-20 Swg	13.10	15.87	6.35	13.10
M10 x 1.5	10-20 Swg	15.50	19.05	7.62	15.50
M12 x 1.75*	10-20 Swg	19.50	25.40	10.16	19.50



\* per ordini personalizzati

## minidadi a coniare

### Dimensioni e specifiche

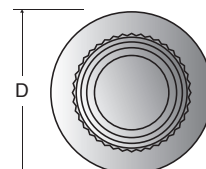
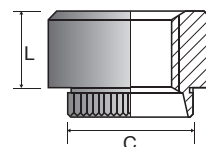

 M	 Standard	 Ø +0.1-0.0	D ±0.13	L ±0.13	C +0.0-0.13
M2.5 X 0.45*	10-20 Swg	4.30	5.50	2.30	4.20
M3 x 0.5	10-20 Swg	4.30	5.50	2.30	4.20
M3.5 x 0.6*	10-20 Swg	5.50	7.00	3.20	5.40
M4 x 0.7	10-20 Swg	5.50	7.00	3.20	5.40
M5 x 0.8	10-20 Swg	6.50	8.50	3.80	6.40
M6 x 1.0	10-20 Swg	7.70	10.00	5.00	7.60
M8 x 1.25	10-20 Swg	9.80	12.00	6.60	9.70



\* per ordini personalizzati

## distanziali a coniare

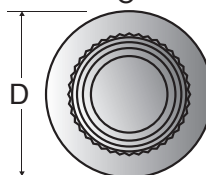
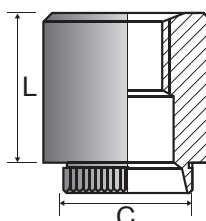

### Dimensioni e specifiche

 M	 Standard	 Ø +0.1-0.0	D ±0.13	L ±0.13	C +0.0-0.13
M2.5 x 0.45	10-20 Swg	5.90	7.92	DEFINITO DAL CLIENTE	5.90
M3 x 0.5	10-20 Swg	5.90	7.92		5.90
M3.5 x 0.6	10-20 Swg	6.95	9.52		6.95
M4 x 0.7	10-20 Swg	6.95	9.52		6.95
M5 x 0.8	10-20 Swg	8.35	11.10		8.35
M6 x 1.0	10-20 Swg	9.65	12.70		9.65
M8 x 1.25	10-20 Swg	13.10	15.87		13.10
M10 x 1.5	10-20 Swg	15.50	19.05		15.50
M12 x 1.75	10-20 Swg	19.50	25.40		19.50



# mini distanziali a coniare

## Dimensioni e specifiche

 M	 Standard	 $\varnothing +0.1 -0.0$	D $\pm 0.13$	L $\pm 0.13$	C $+0.0 -0.13$
M2.5 x 0.45	10-20 Swg	4.30	5.55	DEFINITO DAL CLIENTE	4.20
M3 x 0.5	10-20 Swg	4.30	5.55		4.20
M3.5 x 0.6	10-20 Swg	5.50	7.00		5.40
M4 x 0.7	10-20 Swg	5.50	7.00		5.40
M5 x 0.8	10-20 Swg	6.50	8.50		6.40
M6 x 1.0	10-20 Swg	7.70	10.00		7.60
M8 x 1.25	10-20 Swg	9.80	12.00		9.70

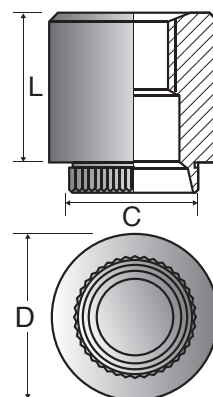

# distanziatori

## Dimensioni e specifiche

N. DI SERIE	Norminel - $\varnothing$	CODICE		H $\pm 0.13$	C Max.	B $\pm 0.13$	D $\pm 0.13$
		LUNGHEZZA (in millimetri)	L $\pm 0.13$				
ASSS	4 mm	-8 -10 -12 -14 -16 -18 -20 -22 -25		6.35	5.38	4.77	3.58
ASSC	4 mm	-8 -10 -12 -14 -16 -18 -20 -22 -25		6.35	5.38	4.77	3.58
ASSA	4 mm	-8 -10 -12 -14 -16 -18 -20 -22 -25		6.35	5.38	4.77	3.58

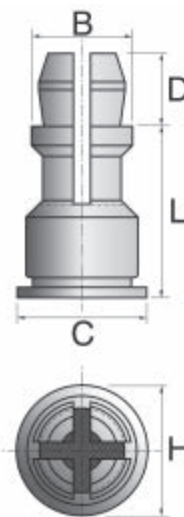

N. DI SERIE	Foro di montaggio inferiore $+0.08$	Fastener Material	Hartness Max.	Foro di montaggio		Fastener Material	Hartness Max.	Range Spessore	Min.	
				Min.	$+0.08$					
ASSS	5.4	Acciaio al carbonio	HRB 60	1	6.6	4.0	PC Board or Metal	No Limit	1 - 1.8	2.5
ASSC	5.4	Acciaio inossidabile	HRB 70	1	6.6	4.0			1 - 1.8	2.5
ASSA	5.4	Alluminio	HRB 50	1	6.6	4.0			1 - 1.8	2.5

# FISSAGGI AUTOBROCCIANTI PER SCHEDE ELETTRONICHE

# dadi autobroccianti

## Dimensioni e specifiche

M	N. DI SERIE		A Shank	MIN.	$\varnothing +0.08 - 0.00$	Min. Dist. C	E $\pm 0.13$	T $\pm 0.13$	Min.
	ACCIAIO ZINCATO	ACCIAIO INOX							
M2.5 x 0.45	AKF2-M2.5	AKFS2-M2.5	1.5	1.5	4.2	4.68	5.56	1.5	4.5
M3 x 0.5	AKF2-M3	AKFS2-M3	1.5	1.5	4.2	4.68	5.56	1.5	4.5
M4 x 0.7	AKF2-M4	AKFS2-M4	1.5	1.5	6.4	6.81	8.74	2.0	6.4
M5 x 0.8	AKF2-M5	AKFS2-M5	1.5	1.5	6.9	7.37	9.53	3.0	7.1

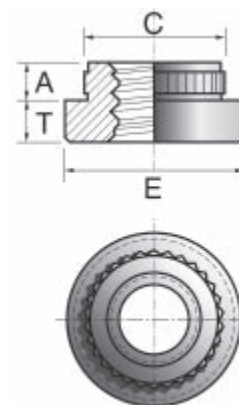

## il nostro Ufficio Tecnico è a Vostra disposizione per informazioni e dimostrazioni dei prodotti

per alcune tipologie di prodotti sono vigenti particolari condizioni di vendita determinate da tempo di consegna e quantità minima ordinabile,

i dati e le caratteristiche citati nel presente catalogo potrebbero subire modifiche nel tempo e sono quindi da considerarsi non impegnativi e da verificare sempre con il nostro Ufficio Tecnico

siamo distributori di prodotti



Via Tiepolo, 21/1-3 - Zona SPZ  
31021 Zerman di Mogliano V.to (TV)  
tel. 041.5970111 - fax 041.5970113  
info@printecsolution.com  
www.printecsolution.com

- puntatura a freddo
- rivetti
- inserti filettati
- prigionieri e boccole a saldare
- guide a sfera di precisione
- chiusure meccaniche
- ruote lamellari
- nastri abrasivi